

## BRITISH OVAL

### DOUBLE KNOB CYLINDER 3061



British oval double knob cylinder 3061

Digital locking cylinder with encapsulated electronic subassembly for installation in doors with British oval profile. It evaluates radio signals from transponders and decides whether the user has access authorisation.

#### PRODUCT VERSIONS:

- Stainless steel finish
- Freely rotating on both sides
- Version with audit trail and time zone management (.ZK)
- Button control version, operated from inside without transponders (.TS)
- Cylinders to be installed in steel and fire retardant doors (.FH)
- Weather-proof version (.WP)
- Version „network inside“ with integrated Lock Node (.WN)
- G2 British Oval cylinder with advanced functionality refer to G2 locking systems

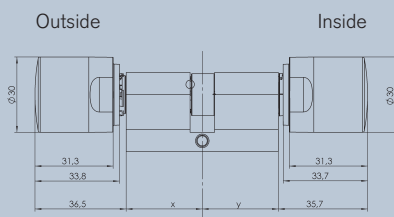

Dimensions in mm

#### TECHNICAL SPECIFICATIONS:

- British oval profile cylinder
- Knob diameter: 30 mm
- Basic construction length: 30–30 mm (outside/inside)
- Total length: max. 140 mm (outside max. 90 mm), larger dimensions on demand
- Protection class: IP 54, version .WP (electronic knob): IP 65
- Battery type: 2 x lithium CR2450 3V
- Battery lifespan: up to 300,000 lockings or up to ten years standby
- Temperature range: operation  $-20\text{ }^{\circ}\text{C}$  to  $+50\text{ }^{\circ}\text{C}$ , storage  $-35\text{ }^{\circ}\text{C}$  to  $+50\text{ }^{\circ}\text{C}$
- 3,000 operations can be recorded
- 5+1 time zone groups (G2: 100)
- Up to 8,000 transponders can be managed per cylinder (G2: 64,000)
- Up to 48,000 lockings can be managed per transponder (G2: 304,000)
- Various duration / opening modi (office function)
- Directly networkable with integrated Lock Node (network cap WN.LN.I) or via external Lock Node with additional door monitoring function
- Upgradeable firmware

## ORDERING DETAILS:

British oval double knob cylinder, standard version	Z4.BO.30-30.FD
Version with audit trail and time zone management	.ZK
Button control version	.TS
Version for cylinders to be installed in steel doors	.FH
Weather-proof version	.WP
Version „network inside“ with integrated Lock Node	.WN
Construction length from 65 to 80 mm total length	e.g. Z4.BO.40-40.FD
Construction length from 85 to 100 mm total length	e.g. Z4.BO.40-60.FD
Construction length from 105 to 140 mm total length	e.g. Z4.BO.65-75.FD
Construction length over 140 mm or over 90 mm on one side	on demand
G2 locking cylinder with advanced functionality refer to G2 locking systems	.G2